

AN ORDINANCE ESTABLISHING HANDICAPPED
PARKING SPACES AT CERTAIN LOCATIONS.

WHEREAS, the City Engineer’s Office has recommended that a revision be made to Chapter 694-49 - Handicap Parking Ordinance for the addition of handicap parking stalls on E. Plum Street and S. Seventh Street; and

WHEREAS, said recommendation has the concurrence of the Vineland Police Department, and the City Solicitor, and is considered to be in the best interest of the City of Vineland; now, therefore,

BE IT ORDAINED BY THE COUNCIL OF THE CITY OF VINELAND THAT:

SECTION 1. The following described locations are hereby designated as Handicapped Parking Spaces:

NAME OF STREET:	SIDE:	LOCATION:
E. Plum Street	North	From a point 43 feet east of the easterly curb line of N. Sixth Street to a point 21 feet easterly thereof.
E. Plum Street	South	From a point 223 feet east of the easterly curb line of N. Sixth Street to a point 22 feet easterly thereof.
S. Seventh Street	East	From a point 40 feet south of the southerly curb line of E Cherry Street to a point 22 feet southerly thereof.
S. Seventh Street	East	From a point 43 feet south of the southerly curb line of E Quince Street to a point 22 feet southerly thereof.
S. Seventh Street	East	From a point 41 feet north of the northerly curb line of E Quince Street to a point 22 feet northerly thereof.
S. Seventh Street	East	From a point 40 feet south of the southerly curb line of E Montrose Street to a point 22 feet southerly thereof.
S. Seventh Street	East	From a point 53 feet north of the northerly curb line of E Montrose Street to a point 22 feet northerly thereof.
S. Seventh Street	East	From a point 63 feet south of the southerly curb line of E Elmer Street to a point 22 feet southerly thereof.

SECTION 2. Signs shall be erected and maintained as authorized by the Commissioner of Transportation of the State of New Jersey.

SECTION 3. All ordinances or parts of ordinances inconsistent with the provisions of this ordinance are hereby repealed to the extent of such inconsistency.

SECTION 4. This Ordinance shall take effect upon passage and publication as provided by law.

Passed first reading:

Passed final reading:

Approved by the Mayor:

President of Council

Mayor

ATTEST:

City Clerk

March 13, 2023

RE: Handicap Parking Stalls
E. Plum Street
Request of Ordinance
City of Vineland, Cumberland County



Bob Dickenson, Business Administrator:

The City's Engineering Division is requesting an ordinance to revise the §694.-49 Handicap Parking ordinance for the addition of handicap parking stalls on E Plum Street between Sixth Street and Seventh Street.

The City installed on-street parking stalls on E. Plum Street between Sixth Street and Seventh Street. The project consisted of linestriping on-street standard and handicap parking stalls. At the handicap parking stalls, handicap accessible concrete sidewalk ramps were installed. Appropriate handicap parking stall signage and pavement parking were also installed.

As such, please prepare an Ordinance for Handicap Parking Stalls at the following locations:

Name of Street	Side	Limits
E. Plum Street	North	From a point 43 feet east of the easterly curb line of N Sixth Street to a point 21 feet easterly thereof.
E. Plum Street	South	From a point 223 feet east of the easterly curb line of N Sixth Street to a point 22 feet easterly thereof.

Should you have any questions and/or comments please feel free to contact me at extension 4098.

Very truly yours,



David J. Maillet, P.E.
City Engineer



Cc: Sgt. Nicholas Dounoulis, Vineland Police Department



March 13, 2023



RE: Handicap Parking Stalls
S. Seventh Street
Request of Ordinance
City of Vineland, Cumberland County

Bob Dickenson, Business Administrator:

The City's Engineering Division is requesting an ordinance to revise the §694.-49 Handicap Parking ordinance for the addition of handicap parking stalls on S Seventh Street between Chestnut Avenue and Elmer Street.

The City will be repaving S. Seventh Street between Chestnut Avenue and Landis Avenue within the next month. The project will consist of an asphalt overlay over existing concrete roadway. At the City's request, the signage and striping plan was revised for on-street parking, a bike lane, additional signage, and handicap parking aisle ramps for each block. Appropriate handicap parking stall signage and striping will be installed once paving has been completed.

Attached for your information is a copy of the revised signage and striping plan (dated March 13, 2023) for S. Seventh Street between Chestnut Avenue and Landis Avenue.

As such, please prepare an Ordinance for Handicap Parking Stalls at the following locations:

Name of Street	Side	Limits
S. Seventh Street	East	From a point 40 feet south of the southerly curb line of E Cherry Street to a point 22 feet southerly thereof.
S. Seventh Street	East	From a point 43 feet south of the southerly curb line of E Quince Street to a point 22 feet southerly thereof.
S. Seventh Street	East	From a point 41 feet north of the northerly curb line of E Quince Street to a point 22 feet northerly thereof.
S. Seventh Street	East	From a point 40 feet south of the southerly curb line of E Montrose Street to a point 22 feet southerly thereof.
S. Seventh Street	East	From a point 53 feet north of the northerly curb line of E Montrose Street to a point 22 feet northerly thereof.
S. Seventh Street	East	From a point 63 feet south of the southerly curb line of E Elmer Street to a point 22 feet southerly thereof.





Should you have any questions and/or comments please feel free to contact me at extension 4098.

Very truly yours,

David J. Maillet, P.E.
City Engineer

Cc: Sgt. Nicholas Dounoulis, Vineland Police Department



Special arrangements for persons with disabilities may be made if requested in advance by contacting the Business Administrator's office at 856-794-4144.

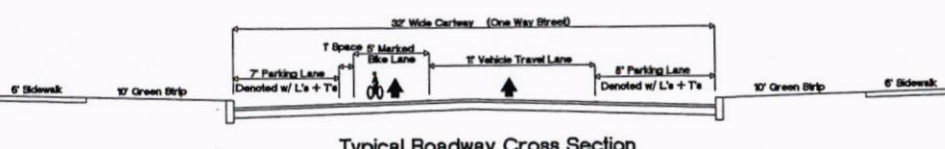
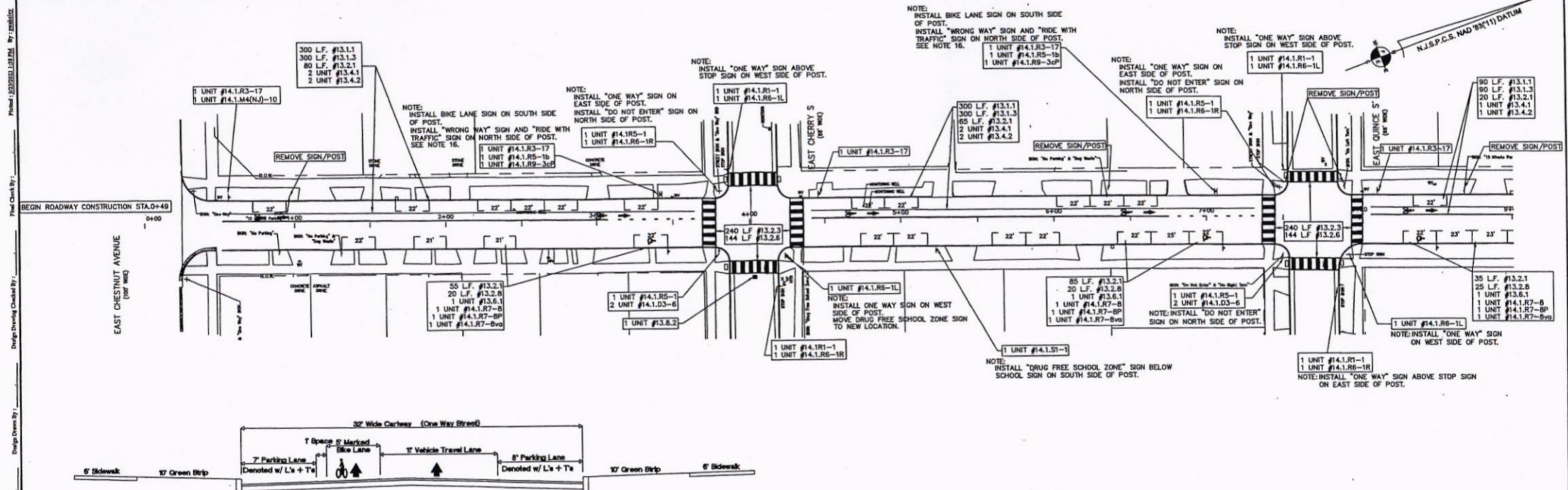

LEGEND (SIGNS NOT TO SCALE):

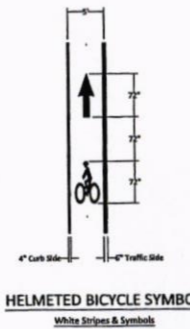
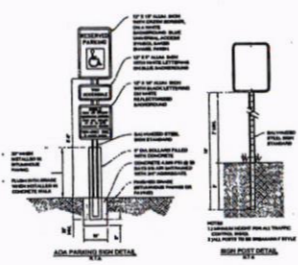

- NOTE:**
1. ALL STOP BARS SHALL BE 24" WHITE, LONG LIFE THERMOPLASTIC.
 2. ALL CROSSWALKS SHALL BE 6" WHITE LONG LIFE THERMOPLASTIC.
 3. BASE SURVEY PERFORMED BY FRALINGER ENGINEERING DATED 4/13/2020.
 4. ALL SIGNS THAT NEED TO BE REMOVED AND REPLACED SHALL ALSO BE INSTALLED IN THE FIELD AT THE LOCATION SHOWN ON THE PLANS.
 5. ALL SIGNS SHALL CONFORM TO MUTCD REQUIREMENTS.
 6. ALL NEW SIGN POSTS SHALL BE U-CHANNEL BREAKAWAY.
 7. ALL CROSSWALKS SHALL BE HIGH VISIBILITY CROSSWALKS AND SHALL CONSIST OF TWO 6" TRANSVERSE LINES AND 24" LONGITUDINAL "LADDER" STYLE PAVEMENT MARKINGS. THE LADDER MARKERS SHALL BE SPACED 24" APART.
 8. EAST SIDE PARKING STALLS TO BE 8 FEET WIDE.
 9. WEST SIDE PARKING STALLS TO BE 7 FEET WIDE.
 10. BIKE LANE TO BE ON WEST SIDE OF THE ROAD. BIKE LANE TO BE 5 FEET WIDE.
 11. ALL PARKING STALLS TO BE MINIMUM 25 FEET FROM CROSSWALK AND 5 FEET FROM DRIVEWAYS.
 12. STANDARD PARKING STALL LINES TO BE 4" WHITE THERMOPLASTIC. HANDICAP PARKING STALL LINES TO BE 4" BLUE THERMOPLASTIC.
 13. RIGHT LINE OF BIKE LANE TO BE 6" WHITE EPOXY. STOP TO BE 2" LINE 16" SPACE. LEFT LINE OF BIKE LANE TO BE 4" WHITE EPOXY.
 14. HATCHING IN NO PARKING AREAS TO BE 24" YELLOW THERMOPLASTIC. NO PARKING AREAS OUTLINED WITH 4" YELLOW THERMOPLASTIC.
 15. ITEM #14.1.R5-1b (WRONG WAY W/BICYCLE SYMBOL) SHALL BE WHITE ON RED.
 16. ITEM #14.1.R9-3cP (RIDE WITH TRAFFIC PLAQUE) SHALL BE MOUNTED DIRECTLY BELOW THE WRONG WAY W/BICYCLE SYMBOL SIGN (ITEM #14.1.R5-1b).

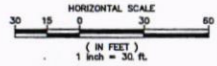

ITEM	DESCRIPTION	UNIT	QUANTITY	ITEM	DESCRIPTION	UNIT	QUANTITY
13.1.1	TRAFFIC STRIPES, LONG LIFE, EPOXY RESIN, 4" WHITE	L.F.	600	14.1.R5-1	SIGN, POST MOUNTED, "STOP" PLAQUE, 24"x12"	UNIT	3
13.1.2	TRAFFIC STRIPES, LONG LIFE, EPOXY RESIN, 4" WHITE	L.F.	600	14.1.R5-1	SIGN, POST MOUNTED, DO NOT ENTER, 20"x30"	UNIT	2
13.2.1	TRAFFIC STRIPES, LONG LIFE, THERMOPLASTIC, 4" WHITE	L.F.	340	14.1.R5-1b	SIGN, POST MOUNTED, WRONG WAY W/BICYCLE SYMBOL, 12"x18"	UNIT	4
13.2.2	TRAFFIC STRIPES, LONG LIFE, THERMOPLASTIC, 4" WHITE	L.F.	480	14.1.R5-1R	SIGN, POST MOUNTED, ONE WAY (RIGHT), 36"x12"	UNIT	4
13.2.6	TRAFFIC STRIPES, LONG LIFE, THERMOPLASTIC, 24" WHITE	L.F.	288	14.1.R5-1L	SIGN, POST MOUNTED, ONE WAY (LEFT), 36"x12"	UNIT	3
13.2.8	TRAFFIC STRIPES, LONG LIFE, THERMOPLASTIC, 4" BLUE	L.F.	60	14.1.R7-8	SIGN, POST MOUNTED, RESERVED PARKING (RES), 12"x18"	UNIT	3
13.4.1	TRAFFIC MARKINGS, LONG LIFE, THERMOPLASTIC, PREFORMED, STRAIGHT ARROW, WHITE	UNIT	5	14.1.R7-8P	SIGN, POST MOUNTED, HC PARKING PENALTY PLAQUE, 10"x12"	UNIT	3
13.4.2	TRAFFIC MARKINGS, LONG LIFE, THERMOPLASTIC, PREFORMED, "BKE" SYMBOL, WHITE	UNIT	5	14.1.R7-8V	SIGN, POST MOUNTED, VAN ACCESSIBLE PLAQUE, 12"x8"	UNIT	3
13.6.1	TRAFFIC MARKINGS, PAINT, HANDICAP SYMBOL, HANDICAP BLUE	UNIT	3	14.1.R9-3cP	SIGN, POST MOUNTED, RIDE WITH TRAFFIC PLAQUE, 12"x12"	UNIT	2
13.8.2	RPM, B-DIRECTIONAL, BLUE LENS	UNIT	1	14.1.R3-1	SIGN, POST MOUNTED, STREET NAME, EXTRUDED BLADE, 36"x9"	UNIT	4
14.1.R1-1	SIGN, POST MOUNTED, STOP, 30"x30"	UNIT	4	14.1.R1-1R	SIGN, POST MOUNTED, SCHOOL ADVANCE WARNING, (P1-Y-1), 28"x36"	UNIT	1
14.1.R3-1	SIGN, POST MOUNTED, BIKE LANE, 30"x24"	UNIT	5				

SOUTH SEVENTH STREET SIGNAGE AND STRIPING PLAN STA.0+00 TO STA.9+01

CITY OF VINELAND STATE OF NEW JERSEY

COUNTY OF CUMBERLAND

SCALE: 1"=30'
FILE #: 21-001

OFFICE OF THE CITY ENGINEER
440 EAST WOOD STREET
VINELAND, NEW JERSEY 08360

DATE: 7/5/2022

DAVID J. MAILLET, City Engineer
Professional Engineer
N.J. License No. 45771

PHONE: (856) 794-4800 FAX: (856) 485-4888

11/16

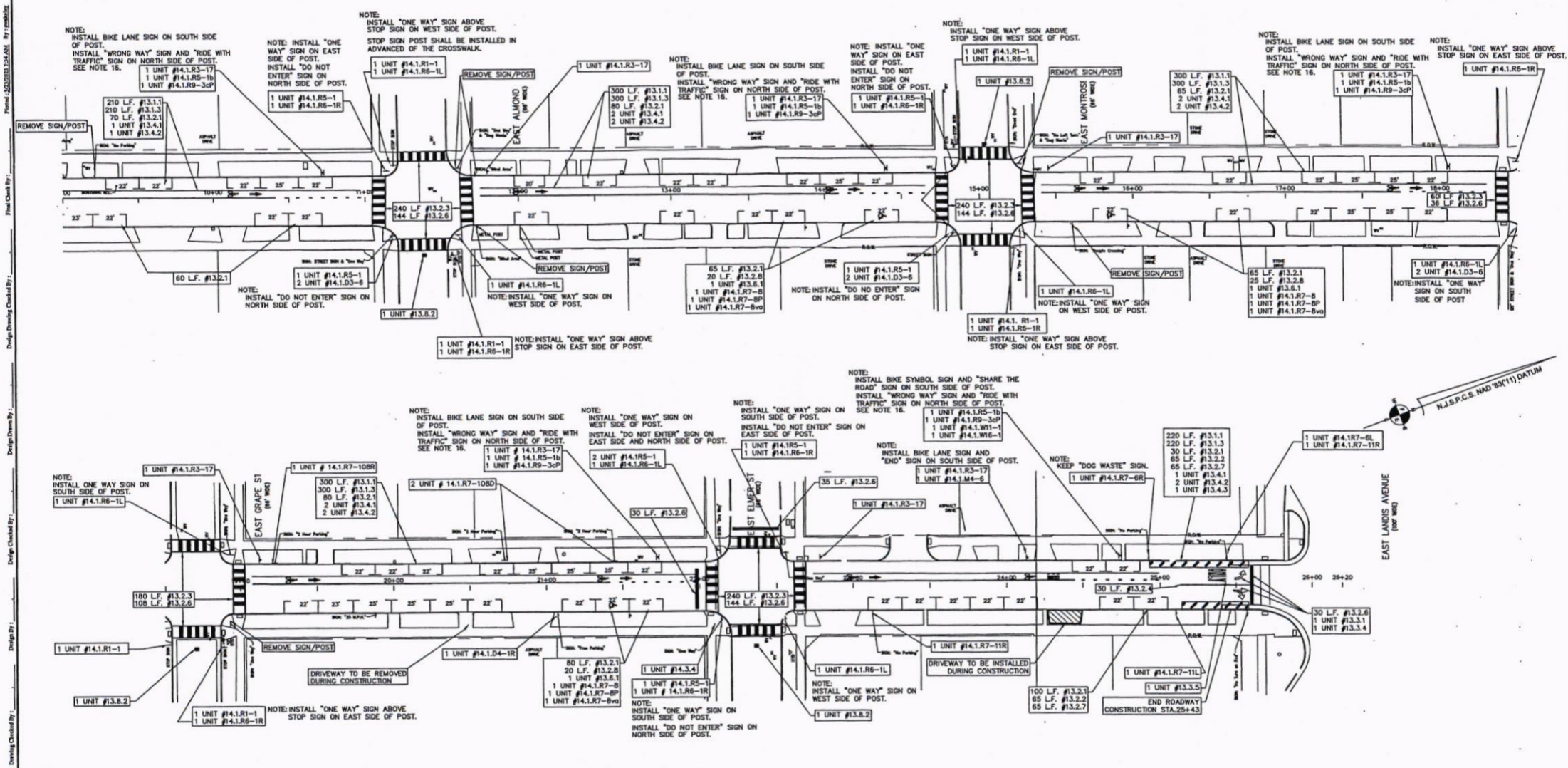

- NOTE:
1. ALL STOP BARS SHALL BE 24" WHITE, LONG LIFE THERMOPLASTIC.
 2. ALL CROSSWALKS SHALL BE 6" WHITE LONG LIFE THERMOPLASTIC.
 3. BASE SURVEY PERFORMED BY FRALINGER ENGINEERING DATED 4/13/2020.
 4. ALL SIGNS THAT NEED TO BE REMOVED AND REPLACED SHALL ALSO BE INSTALLED IN THE FIELD AT THE LOCATION SHOWN ON THE PLANS.
 5. ALL SIGNS SHALL CONFORM TO MUTCD REQUIREMENTS.
 6. ALL NEW SIGN POSTS SHALL BE 0"-CHANNEL BREAKAWAY.
 7. ALL CROSSWALKS SHALL BE HIGH VISIBILITY CROSSWALKS AND SHALL CONSIST OF TWO 6" TRANSVERSE LINES AND 24" LONGITUDINAL "LADDER" STYLE PAVEMENT MARKINGS. THE LADDER MARKERS SHALL BE SPACED 24" APART.
 8. EAST SIDE PARKING STALLS TO BE 8 FEET WIDE.
 9. WEST SIDE PARKING STALLS TO BE 7 FEET WIDE.

10. BIKE LANE TO BE ON WEST SIDE OF THE ROAD. BIKE LANE TO BE 5 FEET WIDE.
11. ALL PARKING STALLS TO BE MINIMUM 25 FEET FROM CROSSWALK AND 5 FEET FROM DRIVEWAYS.
12. STANDARD PARKING STALL LINES TO BE 4" WHITE THERMOPLASTIC. HANDICAP PARKING STALL LINES TO BE 4" BLUE THERMOPLASTIC.
13. RIGHT LINE OF BIKE LANE TO BE 6" WHITE EPOXY. SHOULDS TO BE 2' LINE 15" SPACE. LEFT LINE OF BIKE LANE TO BE 4" WHITE EPOXY.
14. HATCHING IN NO PARKING AREAS TO BE 24" YELLOW THERMOPLASTIC. NO PARKING AREAS OUTLINED WITH 4" YELLOW THERMOPLASTIC.
15. ITEM #14.1.R5-1b (WRONG WAY W/BICYCLE SYMBOL) SHALL BE WHITE ON RED.
16. ITEM #14.1.R9-3p (RIDE WITH TRAFFIC PLAQUE) SHALL BE MOUNTED DIRECTLY BELOW THE WRONG WAY W/BICYCLE SYMBOL SIGN (ITEM #14.1.R5-1b).

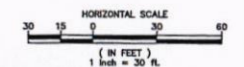

ITEM	DESCRIPTION	UNIT	QUANTITY	ITEM	DESCRIPTION	UNIT	QUANTITY	ITEM	DESCRIPTION	UNIT	QUANTITY
13.1.1	TRAFFIC STRIPES, LONG LIFE, EPOXY RESIN, 4" WHITE	L.F.	1,330	13.8.1	TRAFFIC MARKINGS, PANE, HANDICAP SYMBOL, HANDICAP BLUE	UNIT	3	14.1.10-04	SIGN, POST MOUNTED, 2 HR PARKING (TIME & DAYS), (DOUBLE ARROW) 12"x18"	UNIT	2
13.1.3	TRAFFIC STRIPES, LONG LIFE, EPOXY RESIN, 6" WHITE	L.F.	1,330	13.8.2	TRAF. B-DIRECTIONAL, BLUE LENS	UNIT	4	14.1.10-11	SIGN, POST MOUNTED, NO PARKING HERE TO CORNER (LEFT ARROW) 12"x18"	UNIT	1
13.2.1	TRAFFIC STRIPES, LONG LIFE, THERMOPLASTIC, 4" WHITE	L.F.	685	14.1.10-11	SIGN, POST MOUNTED, STOP, 30"x30"	UNIT	6	14.1.10-18	SIGN, POST MOUNTED, NO PARKING HERE TO CORNER (RIGHT ARROW) 12"x18"	UNIT	2
13.2.2	TRAFFIC STRIPES, LONG LIFE, THERMOPLASTIC, 4" YELLOW	L.F.	130	14.1.10-27	SIGN, POST MOUNTED, BICYCLE LANE, 30"x24"	UNIT	9	14.1.10-30	SIGN, POST MOUNTED, RIDE WITH TRAFFIC PLAQUE, 12"x12"	UNIT	5
13.2.3	TRAFFIC STRIPES, LONG LIFE, THERMOPLASTIC, 6" WHITE	L.F.	960	14.1.10-31	SIGN, POST MOUNTED, "END" PLAQUE, 24"x12"	UNIT	1	14.1.10-31	SIGN, POST MOUNTED, BICYCLE MARKING, (R) 1'-0", 30"x30"	UNIT	1
13.2.4	TRAFFIC STRIPES, LONG LIFE, THERMOPLASTIC, 8" WHITE	L.F.	30	14.1.10-32	SIGN, POST MOUNTED, DO NOT ENTER, 30"x30"	UNIT	8	14.1.10-32	SIGN, POST MOUNTED, SHARE THE ROAD, (R) 1'-0", 18"x24"	UNIT	8
13.2.6	TRAFFIC STRIPES, LONG LIFE, THERMOPLASTIC, 24" WHITE	L.F.	671	14.1.10-33	SIGN, POST MOUNTED, WRONG WAY W/BICYCLE SYMBOL, 12"x18"	UNIT	5	14.1.10-34	SIGN, POST MOUNTED, STREET NAME, EXTENDED BLADE, 36"x6"	UNIT	6
13.2.7	TRAFFIC STRIPES, LONG LIFE, THERMOPLASTIC, 24" YELLOW	L.F.	130	14.1.10-34	SIGN, POST MOUNTED, ONE WAY (RIGHT), 36"x12"	UNIT	8	14.1.10-35	SIGN, POST MOUNTED, PARKING AREA (RIGHT ARROW) 24"x18"	UNIT	1
13.2.8	TRAFFIC STRIPES, LONG LIFE, THERMOPLASTIC, 4" BLUE	L.F.	65	14.1.10-35	SIGN, POST MOUNTED, ONE WAY (LEFT), 36"x12"	UNIT	8	14.1.10-36	SIGN, POST MOUNTED, SCHOOL ADVANCE WARNING, (1'-0"), 28"x28"	UNIT	1
13.3.1	TRAFFIC MARKINGS, LONG LIFE, THERMOPLASTIC, LEFT ARROW, WHITE	UNIT	1	14.1.10-36	SIGN, POST MOUNTED, NO PARKING LOADING ZONE (LEFT ARROW), 12"x18"	UNIT	1	14.1.10-37	SIGN, OVERHEAD STREET NAME (-), 48"x18" (MAST ARM MOUNTED)	UNIT	1
13.3.4	TRAFFIC MARKINGS, LONG LIFE, THERMOPLASTIC, COMBINATION ARROW, WHITE	UNIT	1	14.1.10-37	SIGN, POST MOUNTED, NO PARKING LOADING ZONE (RIGHT ARROW), 12"x18"	UNIT	1				
13.3.5	TRAFFIC MARKINGS, LONG LIFE, THERMOPLASTIC, "ONLY" LEGEND, WHITE	UNIT	1	14.1.10-38	SIGN, POST MOUNTED, RESERVED PARKING (R), 12"x18"	UNIT	3				
13.4.1	TRAFFIC MARKINGS, LONG LIFE, THERMOPLASTIC, PERFORMED, STRAIGHT ARROW, WHITE	UNIT	8	14.1.10-39	SIGN, POST MOUNTED, HC PARKING PENALTY PLAQUE, 10"x12"	UNIT	3				
13.4.2	TRAFFIC MARKINGS, LONG LIFE, THERMOPLASTIC, PERFORMED, "BIKE" SYMBOL, WHITE	UNIT	9	14.1.10-40	SIGN, POST MOUNTED, VAN ACCESSIBLE PLAQUE, 12"x6"	UNIT	3				
13.4.3	TRAFFIC MARKINGS, LONG LIFE, THERMOPLASTIC, PERFORMED, "END" LEGEND, WHITE	UNIT	1	14.1.10-41	SIGN, POST MOUNTED, 2 HR PARKING (TIME & DAYS), (RIGHT ARROW) 12"x18"	UNIT	1				

**SOUTH SEVENTH STREET
SIGNAGE AND STRIPING PLAN
STA. 9+01 TO STA. 26+20**

CITY OF VINELAND
COUNTY OF CUMBERLAND STATE OF NEW JERSEY

SCALE: 1"=30'
FILE #: 21-001

OFFICE OF THE CITY ENGINEER
640 EAST WOOD STREET
VINELAND, NEW JERSEY 08360

DATE: 7/5/2022

DAVID J. MAILLET, City Engineer
Professional Engineer
N.J. License No. 45771

12
16

FAX: (856) 693-4066