

ORDINANCE NO. 2023- 30

AN ORDINANCE ESTABLISHING A BICYCLE LANE ON S. SEVENTH STREET BETWEEN CHESTNUT AVENUE AND LANDIS AVENUE.

WHEREAS, the City Engineer’s Office has recommended that the City establish a Bicycle Lane on S. Seventh between Chestnut Avenue and Landis Avenue; and

WHEREAS, said recommendation has been reviewed by the City Engineer’s Office, the Vineland Police Department, and the City Solicitor, and is considered to be in the best interest of the City of Vineland; now, therefore,

BE IT ORDAINED BY THE COUNCIL OF THE CITY OF VINELAND THAT:

**SECTION 1.** The certain part of Seventh Street as described in this subsection is hereby designated and established as a bicycle lane. No vehicle other than a bicycle shall be permitted the use of said lane:

<b>Name of Street</b>	<b>Along Side</b>	<b>Direction</b>	<b>Limits</b>
S. Seventh Street	West	Northbound	From Chestnut Ave to Landis Avenue

**SECTION 2.** Signs shall be erected and maintained as authorized by the Commissioner of Transportation of the State of New Jersey.

**SECTION 3.** All other ordinances or parts of ordinances inconsistent with the provisions of this ordinance are hereby repealed to the extent of such inconsistency.

**SECTION 4.** This Ordinance shall take effect upon passage and publication as provided by law.

Passed first reading:

Passed final reading:

Approved by the Mayor:

\_\_\_\_\_  
President of Council

\_\_\_\_\_  
Mayor

ATTEST:

\_\_\_\_\_  
City Clerk



David J. Maillet, PE  
City Engineer  
dmaillet@vinelandcity.org  
www.vinelandcity.org

640 E. Wood Street  
PO Box 1508  
Vineland, NJ 08362-1508  
Phone: (856) 794-4090  
Fax: (856) 405-4606

March 13, 2023



RE: Bicycle Lane  
S. Seventh Street  
Request of Ordinance  
City of Vineland, Cumberland County

Bob Dickenson, Business Administrator:

The City's Engineering Division is requesting an ordinance to revise the §694.-51.1 Bicycle Lanes Established ordinance for the addition of a bicycle lane on S Seventh Street between Chestnut Avenue and Landis Avenue.

The City will be repaving S. Seventh Street between Chestnut Avenue and Landis Avenue within the next month. The project will consist of an asphalt overlay over existing concrete roadway. At the City's request, the signage and striping plan was revised for on-street parking, a bike lane, additional signage, and handicap parking aisle ramps for each block. Appropriate bicycle lane signage and striping will be installed once paving has been completed.

Attached for your information is a copy of the revised signage and striping plan (dated March 13, 2023) for S. Seventh Street between Chestnut Avenue and Landis Avenue.

As such, please prepare an Ordinance for Bicycle Lanes Established at the following location:

Name of Street	Side	Direction	Limits
S. Seventh Street	West	Northbound	From Chestnut Avenue to Landis Ave

Should you have any questions and/or comments please feel free to contact me at extension 4098.

Very truly yours,

David J. Maillet, P.E.  
City Engineer

Cc: Sgt. Nicolaos Dounoulis, Vineland Police Department



Special arrangements for persons with disabilities may be made if requested in advance by contacting the Business Administrator's office at 856-794-4144.



Design Checked By: [Blank] Design Drawn By: [Blank] Design Checked By: [Blank] Design Drawn By: [Blank] Design Checked By: [Blank] Design Drawn By: [Blank] Design Checked By: [Blank] Design Drawn By: [Blank] Design Checked By: [Blank] Design Drawn By: [Blank]

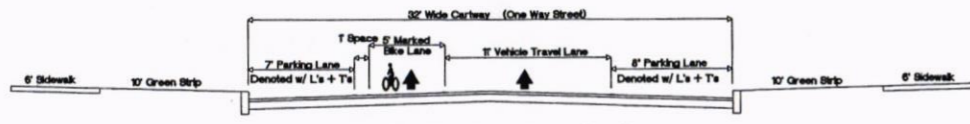
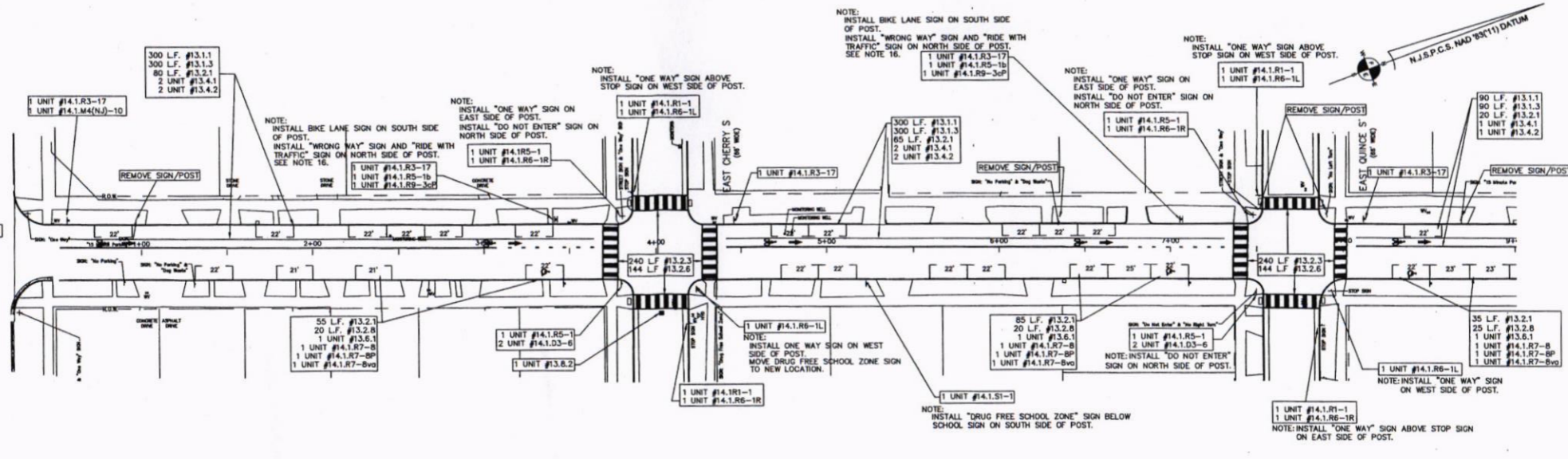

Typical Roadway Cross Section

LEGEND (SIGNS NOT TO SCALE):

R1-1 30" x 30"	R5-1b 12" x 18"	R7-6R 12" x 18"	R7-8va 12" x 6"	R7-11L 12" x 18"	W11-1 30" x 30"	D4-1R 24" x 18"
R3-17 30" x 24"	R6-1R 36" x 12"	R7-10R 12" x 18"	R7-108R 12" x 18"	R7-11R 12" x 18"	W16-1 18" x 24"	S1-1 36" x 36"
M4-6 24" x 12"	R6-1L 36" x 12"	R7-108D 12" x 18"	R7-108D 12" x 18"	R7-11R 12" x 18"	Quince St W16-1 18" x 24"	S1-1 36" x 36"
M4(NJ)-10 24" x 12"	R7-6L 12" x 18"	R7-8P 12" x 10"	R7-108D 12" x 18"	R7-11R 12" x 18"	D3-6 36" x 9"	S1-1 36" x 36"
R5-1 30" x 30"	R7-6L 12" x 18"	R7-8P 12" x 10"	R7-108D 12" x 18"	R7-11R 12" x 18"	R9-3cP 12" x 12"	S1-1 36" x 36"

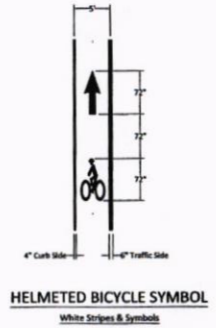
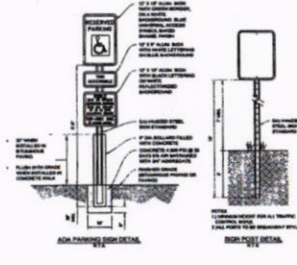

HELMETED BICYCLE SYMBOL  
White Stripes & Symbols  
NTS

- NOTE:
1. ALL STOP BARS SHALL BE 24" WHITE LONG LIFE THERMOPLASTIC.
  2. ALL CROSSWALKS SHALL BE 6" WHITE LONG LIFE THERMOPLASTIC.
  3. BASE SURVEY PERFORMED BY FRALINGER ENGINEERING DATED 4/13/2020.
  4. ALL SIGNS THAT NEED TO BE REMOVED AND REPLACED SHALL ALSO BE INSTALLED IN THE FIELD AT THE LOCATION SHOWN ON THE PLANS.
  5. ALL SIGNS SHALL CONFORM TO MUTCD REQUIREMENTS.
  6. ALL NEW SIGN POSTS SHALL BE U-CHANNEL BREAKAWAY.
  7. ALL CROSSWALKS SHALL BE HIGH VISIBILITY CROSSWALKS AND SHALL CONSIST OF TWO 6" TRANSVERSE LINES AND 24" LONGITUDINAL "LADDER" STYLE PAVEMENT MARKINGS. THE LADDER MARKERS SHALL BE SPACED 24" APART.
  8. EAST SIDE PARKING STALLS TO BE 8 FEET WIDE.
  9. WEST SIDE PARKING STALLS TO BE 7 FEET WIDE.
  10. BIKE LANE TO BE ON WEST SIDE OF THE ROAD. BIKE LANE TO BE 5 FEET WIDE.
  11. ALL PARKING STALLS TO BE MINIMUM 25 FEET FROM CROSSWALK AND 5 FEET FROM DRIVEWAYS.
  12. STANDARD PARKING STALL LINES TO BE 4" WHITE THERMOPLASTIC. HANDICAP PARKING STALL LINES TO BE 4" BLUE THERMOPLASTIC.
  13. RIGHT LINE OF BIKE LANE TO BE 6" WHITE EPOXY. SHOULDS TO BE 2" LINE 18" SPACE. LEFT LINE OF BIKE LANE TO BE 4" WHITE EPOXY.
  14. HATCHING IN NO PARKING AREAS TO BE 24" YELLOW THERMOPLASTIC. NO PARKING AREAS OUTLINED WITH 4" YELLOW THERMOPLASTIC.
  15. ITEM #14.1.R5-1b (WRONG WAY W/BICYCLE SYMBOL) SHALL BE WHITE ON RED.
  16. ITEM #14.1.R9-3cP (RIDE WITH TRAFFIC PLAQUE) SHALL BE MOUNTED DIRECTLY BELOW THE WRONG WAY W/BICYCLE SYMBOL SIGN (ITEM #14.1.R5-1b).

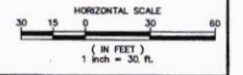

ITEM	DESCRIPTION	UNIT	QUANTITY	ITEM	DESCRIPTION	UNIT	QUANTITY
13.1.1	TRAFFIC STRIPES, LONG LIFE, EPOXY RESIN, 4" WHITE	L.F.	890	14.1.10-1	SIGN, POST MOUNTED, "BEGIN" PLAQUE, 24"x12"	UNIT	1
13.1.3	TRAFFIC STRIPES, LONG LIFE, EPOXY RESIN, 6" WHITE	L.F.	890	14.1.10-1	SIGN, POST MOUNTED, DO NOT ENTER, 30"x30"	UNIT	4
13.2.1	TRAFFIC STRIPES, LONG LIFE, THERMOPLASTIC, 4" WHITE	L.F.	340	14.1.10-1a	SIGN, POST MOUNTED, WRONG WAY W/BICYCLE SYMBOL, 12"x18"	UNIT	2
13.2.3	TRAFFIC STRIPES, LONG LIFE, THERMOPLASTIC, 6" WHITE	L.F.	480	14.1.10-1R	SIGN, POST MOUNTED, ONE WAY (RIGHT), 36"x12"	UNIT	4
13.2.6	TRAFFIC STRIPES, LONG LIFE, THERMOPLASTIC, 24" WHITE	L.F.	208	14.1.10-1a	SIGN, POST MOUNTED, ONE WAY (LEFT), 36"x12"	UNIT	4
13.2.8	TRAFFIC STRIPES, LONG LIFE, THERMOPLASTIC, 4" BLUE	L.F.	65	14.1.10-1a	SIGN, POST MOUNTED, RESERVED PARKING (HCS), 12"x18"	UNIT	3
13.4.1	TRAFFIC MARKINGS, LONG LIFE, THERMOPLASTIC, PREFORMED, STRAIGHT ARROW, WHITE	UNIT	5	14.1.10-1a	SIGN, POST MOUNTED, HC PARKING PENALTY PLAQUE, 10"x12"	UNIT	3
13.4.2	TRAFFIC MARKINGS, LONG LIFE, THERMOPLASTIC, PREFORMED, "BIKE" SYMBOL, WHITE	UNIT	5	14.1.10-1a	SIGN, POST MOUNTED, VAN ACCESSIBLE PLAQUE, 12"x6"	UNIT	3
13.6.1	TRAFFIC MARKINGS, PAINT, HANDICAP SYMBOL, HANDICAP BLUE	UNIT	3	14.1.10-3aP	SIGN, POST MOUNTED, RIDE WITH TRAFFIC PLAQUE, 12"x12"	UNIT	2
13.6.2	TRIAL, B-DIRECTIONAL, BLUE LENS	UNIT	1	14.1.10-3	SIGN, POST MOUNTED, STREET NAME, EXTENDED BLADE, 36"x36"	UNIT	4
14.1.10-1	SIGN, POST MOUNTED, STOP, 30"x30"	UNIT	4	14.1.10-1	SIGN, POST MOUNTED, SCHOOL ADVANCE WARNING, (1) T-5, 24"x36"	UNIT	1
14.1.10-17	SIGN, POST MOUNTED, BICYCLE LANE, 30"x24"	UNIT	5				

SOUTH SEVENTH STREET  
SIGNAGE AND STRIPING PLAN  
STA.0+00 TO STA.9+01

CITY OF VINELAND

COUNTY OF CUMBERLAND STATE OF NEW JERSEY

SCALE: 1"=30'  
FILE #: 21-001

OFFICE OF THE CITY ENGINEER  
640 EAST WOOD STREET  
VINELAND, NEW JERSEY 08360

DATE: 7/5/2022

Professional Engineer  
N.J. License No. 45771

11  
16



Drawing Name: *South Seventh Street Signage and Striping Plan*  
 Drawing Checked By: *[Name]*  
 Design Checked By: *[Name]*  
 Design Drawn By: *[Name]*  
 Date: *12/20/20*

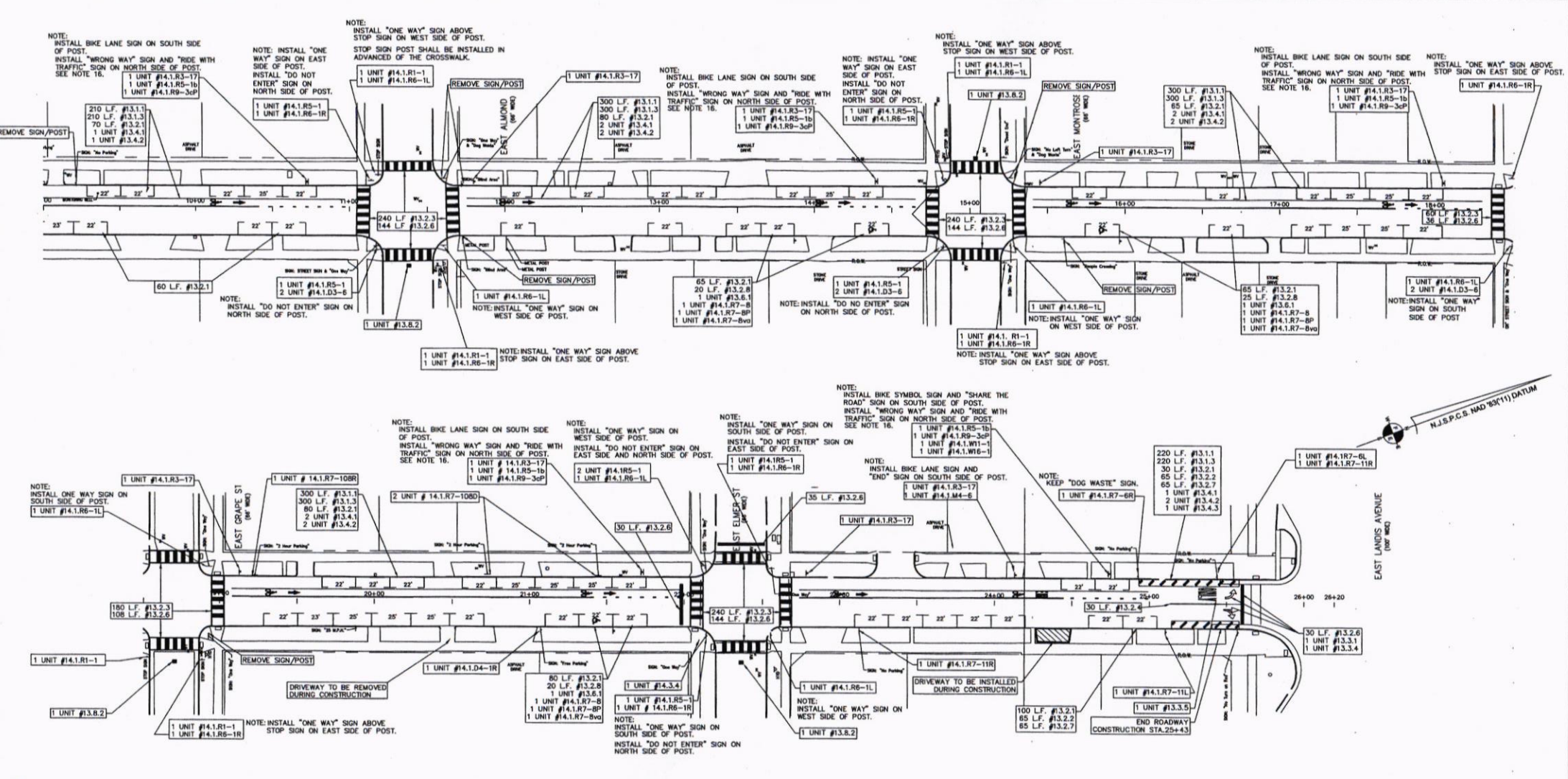

- NOTE:
1. ALL STOP BARS SHALL BE 24" WHITE, LONG LIFE THERMOPLASTIC.
  2. ALL CROSSWALKS SHALL BE 6" WHITE LONG LIFE THERMOPLASTIC.
  3. BASE SURVEY PERFORMED BY FRALINGER ENGINEERING DATED 4/13/2020.
  4. ALL SIGNS THAT NEED TO BE REMOVED AND REPLACED SHALL ALSO BE INSTALLED IN THE FIELD AT THE LOCATION SHOWN ON THE PLANS.
  5. ALL SIGNS SHALL CONFORM TO MUTCD REQUIREMENTS.
  6. ALL NEW SIGN POSTS SHALL BE U-CHANNEL BREAKAWAY.
  7. ALL CROSSWALKS SHALL BE HIGH VISIBILITY CROSSWALKS AND SHALL CONSIST OF TWO 6" TRANSVERSE LINES AND 24" LONGITUDINAL "LADDER" STYLE PAVEMENT MARKINGS. THE LADDER MARKINGS SHALL BE SPACED 24" APART.
  8. EAST SIDE PARKING STALLS TO BE 8 FEET WIDE.
  9. WEST SIDE PARKING STALLS TO BE 7 FEET WIDE.
  10. BIKE LANE TO BE ON WEST SIDE OF THE ROAD. BIKE LANE TO BE 5 FEET WIDE.
  11. ALL PARKING STALLS TO BE MINIMUM 25 FEET FROM CROSSWALK AND 5 FEET FROM DRIVEWAYS.
  12. STANDARD PARKING STALL LINES TO BE 4" WHITE THERMOPLASTIC. HANDICAP PARKING STALL LINES TO BE 4" BLUE THERMOPLASTIC.
  13. RIGHT LINE OF BIKE LANE TO BE 6" WHITE EPOXY. SKIPS TO BE 2" LINE 18" SPACE. LEFT LINE OF BIKE LANE TO BE 4" WHITE EPOXY.
  14. HATCHING IN NO PARKING AREAS TO BE 24" YELLOW THERMOPLASTIC. NO PARKING AREAS OUTLINED WITH 4" YELLOW THERMOPLASTIC.
  15. ITEM #14.1.R5-1b (WRONG WAY W/BICYCLE SYMBOL) SHALL BE MOUNTED ON RED.
  16. ITEM #14.1.R3-3p (RIE WITH TRAFFIC PLAQUE) SHALL BE MOUNTED DIRECTLY BELOW THE WRONG WAY W/BICYCLE SYMBOL SIGN (ITEM #14.1.R5-1b).

ITEM	DESCRIPTION	UNIT	QUANTITY	ITEM	DESCRIPTION	UNIT	QUANTITY
13.1.1	TRAFFIC STRIPES, LONG LIFE, EPOXY RESIN, 4" WHITE	L.F.	1,330	13.8.1	TRAFFIC MARKINGS, PAINT, HANDICAP SYMBOL, HANDICAP BLUE	UNIT	3
13.1.2	TRAFFIC STRIPES, LONG LIFE, EPOXY RESIN, 6" WHITE	L.F.	1,330	13.8.2	RPA, BI-DIRECTIONAL, BLUE LENS	UNIT	4
13.2.1	TRAFFIC STRIPES, LONG LIFE, THERMOPLASTIC, 4" WHITE	L.F.	885	14.1.R1-1	SIGN, POST MOUNTED, STOP, 30"x30"	UNIT	6
13.2.2	TRAFFIC STRIPES, LONG LIFE, THERMOPLASTIC, 4" YELLOW	L.F.	130	14.1.R3-17	SIGN, POST MOUNTED, BICYCLE LANE, 30"x24"	UNIT	9
13.2.3	TRAFFIC STRIPES, LONG LIFE, THERMOPLASTIC, 6" WHITE	L.F.	960	14.1.R5-1	SIGN, POST MOUNTED, "END" PLAQUE, 24"x12"	UNIT	1
13.2.4	TRAFFIC STRIPES, LONG LIFE, THERMOPLASTIC, 6" WHITE	L.F.	30	14.1.R5-1b	SIGN, POST MOUNTED, SHARE THE ROAD, (R) 1'-0", 30"x30"	UNIT	1
13.2.6	TRAFFIC STRIPES, LONG LIFE, THERMOPLASTIC, 24" YELLOW	L.F.	671	14.1.R6-1L	SIGN, POST MOUNTED, WRONG WAY W/BICYCLE SYMBOL, 12"x18"	UNIT	8
13.2.7	TRAFFIC STRIPES, LONG LIFE, THERMOPLASTIC, 24" YELLOW	L.F.	130	14.1.R6-1R	SIGN, POST MOUNTED, ONE WAY (RIGHT), 36"x12"	UNIT	8
13.2.8	TRAFFIC STRIPES, LONG LIFE, THERMOPLASTIC, 4" BLUE	L.F.	65	14.1.R7-1R	SIGN, POST MOUNTED, ONE WAY (LEFT), 36"x12"	UNIT	8
13.3.1	TRAFFIC MARKINGS, LONG LIFE, THERMOPLASTIC, LEFT ARROW, WHITE	UNIT	1	14.1.R7-1L	SIGN, POST MOUNTED, NO PARKING LOADING ZONE (LEFT ARROW), 12"x18"	UNIT	1
13.3.2	TRAFFIC MARKINGS, LONG LIFE, THERMOPLASTIC, COMBINATION ARROW, WHITE	UNIT	1	14.1.R7-2	SIGN, POST MOUNTED, NO PARKING LOADING ZONE (RIGHT ARROW), 12"x18"	UNIT	1
13.3.3	TRAFFIC MARKINGS, LONG LIFE, THERMOPLASTIC, "ONLY" LEGEND, WHITE	UNIT	1	14.1.R7-3P	SIGN, POST MOUNTED, RESERVED PARKING (OC), 12"x18"	UNIT	3
13.4.1	TRAFFIC MARKINGS, LONG LIFE, THERMOPLASTIC, PERFORMED, STRAIGHT ARROW, WHITE	UNIT	8	14.1.R7-3B	SIGN, POST MOUNTED, HC PARKING PENALTY PLAQUE, 10"x12"	UNIT	3
13.4.2	TRAFFIC MARKINGS, LONG LIFE, THERMOPLASTIC, PERFORMED, "BIKE" SYMBOL, WHITE	UNIT	9	14.1.R7-3B	SIGN, POST MOUNTED, VAN ACCESSIBLE PLAQUE, 12"x6"	UNIT	3
13.4.3	TRAFFIC MARKINGS, LONG LIFE, THERMOPLASTIC, PERFORMED, "END" LEGEND, WHITE	UNIT	1	14.1.R7-10BR	SIGN, POST MOUNTED, 2 HR PARKING (TIME & DAYS), (RIGHT ARROW) 12"x18"	UNIT	1

UNIT	QUANTITY	ITEM	DESCRIPTION	UNIT	QUANTITY
14.1.R3-17	9	14.1.R3-17	SIGN, POST MOUNTED, BICYCLE LANE, 30"x24"	14.1.R5-1	1
14.1.R5-1	1	14.1.R5-1	SIGN, POST MOUNTED, "END" PLAQUE, 24"x12"	14.1.R5-1b	1
14.1.R5-1b	1	14.1.R5-1b	SIGN, POST MOUNTED, SHARE THE ROAD, (R) 1'-0", 30"x30"	14.1.R6-1L	8
14.1.R6-1L	8	14.1.R6-1L	SIGN, POST MOUNTED, WRONG WAY W/BICYCLE SYMBOL, 12"x18"	14.1.R6-1R	8
14.1.R6-1R	8	14.1.R6-1R	SIGN, POST MOUNTED, ONE WAY (RIGHT), 36"x12"	14.1.R7-1R	8
14.1.R7-1R	8	14.1.R7-1R	SIGN, POST MOUNTED, ONE WAY (LEFT), 36"x12"	14.1.R7-1L	1
14.1.R7-1L	1	14.1.R7-1L	SIGN, POST MOUNTED, NO PARKING LOADING ZONE (LEFT ARROW), 12"x18"	14.1.R7-2	1
14.1.R7-2	1	14.1.R7-2	SIGN, POST MOUNTED, NO PARKING LOADING ZONE (RIGHT ARROW), 12"x18"	14.1.R7-3P	3
14.1.R7-3P	3	14.1.R7-3P	SIGN, POST MOUNTED, RESERVED PARKING (OC), 12"x18"	14.1.R7-3B	3
14.1.R7-3B	3	14.1.R7-3B	SIGN, POST MOUNTED, HC PARKING PENALTY PLAQUE, 10"x12"	14.1.R7-3B	3
14.1.R7-3B	3	14.1.R7-3B	SIGN, POST MOUNTED, VAN ACCESSIBLE PLAQUE, 12"x6"	14.1.R7-10BR	1
14.1.R7-10BR	1	14.1.R7-10BR	SIGN, POST MOUNTED, 2 HR PARKING (TIME & DAYS), (RIGHT ARROW) 12"x18"		

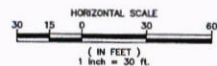

**SOUTH SEVENTH STREET  
SIGNAGE AND STRIPING PLAN  
STA. 9+01 TO STA. 26+20**

CITY OF VINELAND  
 COUNTY OF CUMBERLAND STATE OF NEW JERSEY  
 OFFICE OF THE CITY ENGINEER  
 640 EAST WOOD STREET  
 VINELAND, NEW JERSEY 08360  
 DATE: 7/5/2022  
 SCALE: 1"=30'  
 FILE #: 21-001  
 DAVID J. MAILLET, City Engineer  
 Professional Engineer  
 N.J. License No. 45771  
 12/16  
 PHONE: (856) 794-4000 FAX: (856) 965-4006